



Newsletter

Jaime Rodriguez, President; (907) 357-2747, email: Jaime@matnet.com
 Verna Pratt, Vice Pres/Program Chair; (907) 333-8212; email akrafts@alaskakrafts.com
 Jamie Smith, Secretary, HC 34 Box 2131, Wasilla, AK 99654
 Florene Carney, Newsletter Ed; (907) 376-5390; email: snowfire@mtaonline.net
 Madge Oswald, Treasurer/Membership 12001 Audubon Dr., Anchorage, AK 99516

Inside this issue:

Codonopsis Mystery	2
Seed Collecting trip to Seward Peninsula	3
Plant Show at ABG	3
Garden Tours—June 7th	4
Garden Tours—June 7th	5
Garden Tours - June 7th	6
Garden Tours- July 25th	7
Garden Tours- July 25th	8
Spring is in the Air	9
Plant Sale at ABG	9
From the President	10
Tiny Primulas	10
Plant Sales a Success	11
Editors Corner	11

Coming Events

- June 3, (Wed) 10:00 a.m. ABG Rock Garden Maintenance
- June 7, (Sun) 1:00 p.m. to 4:00 p.m. Garden Visits (see article inside Newsletter)
- June 17, (Wed) 10:00 a.m. ABG Rock Garden Maintenance
- June 20 & 21 (Sat. & Sun.) Garden Fair Contact Verna at 333-8212 Regarding Plant Sales (Before June 7th or after June 16th) Contact Carmel regarding Plant Displays at 522-3490 or garden@gci.net
- July 1, (Wed) 10:00 a.m. ABG Rock Garden Maintenance
- July 15, (Wed) 10:00 a.m. ABG Rock Garden Maintenance
- July 18, 19 (Sat. & Sun.) Les Brakes Coyote Gardens Open. Contact Verna (333-8212) if you can help on Sat. She has the list of volunteers.
- July 25, (Sat) Garden Visits. (See article inside Newsletter for more information)
- July 29 (Wed) 10:00 a.m. ABG Rock Garden Maintenance
- August 1 (Sat) Seed Collecting trip to Arctic Valley. Meet at Fred Meyers on Muldoon, under the sign on Debarr Rd. at 10:00 a.m. Bring food drink, and seed collecting items. Contact Verna at 333-8212
- Aug. 6, 7, 8,9,10 Seed Collecting Trip to the Seward Peninsula (See inside Newsletter)

Coming Events (Cont'd)

- August 12, (Wed) 10:00 a.m. ABG Rock Garden Maintenance.
- August 26 (Wed) 10:00 a.m. ABG Rock Garden Maintenance.
- September 17, (Sat) 2:00 p.m. Monthly Meeting – Palmer
- September 18, (Sun) 2:00 p.m. ABG Rock Garden Fall Clean-up

Codonopsis Mystery

By Debbie Hinchey

(Debbie is a Founding Member of ARGS and a regular contributor to the Newsletter)

I have been growing a *Codonopsis* that Carmel Tysver gave me ten years ago. Her seed packet said *Codonopsis bhutanica*. From the few places I can find this name, it sounds like this is not what I have.

In *Dwarf Campanulas and Associated Genera*, by Graham Nicholls (2006) he mentions that the flowers are a “delicate purple color similar to typical *Fritillaria meleagris*.” This is not what I have.

The flowers are a blue-washed white color with delicate purple markings inside (that you must take time to look into the bell-shaped flowers to see.) The plant is close to two feet tall – perhaps, because it is being crowded by the larger perennials in the garden. The leaves are a bit fuzzy and come out of the ground in a nice little mound. It is always a surprise in May that I still have it because each in April there is no sign what so ever that a plant ever grew in that spot.

The spot is sunny and usually mulched each winter by a *Delphinium* (growing about four feet away) that falls on it. The soil is loam and the plant is placed so that there is a slight (1-2-inch) rise to help with drainage.

I like any (maybe I better say “most”) charming plant(s) that hangs around for a decade. Now that we have become friends, I would like to know its proper name. Does anyone else grow this and know its name?



Seed Collecting Trip to the Seward Peninsula

Verna Pratt

(Verna is a Past President, current Vice-President/Program Chair, Founding Member, and regular contributor to the Newsletter)

A Seed Collecting trip to the Seward Peninsula is planned for August 6, 7, 8, 9 and 10th. Call Verna (333-8212) to indicate your interest. We are renting a 15 passenger van (10-12 people). We will need another vehicle if more participate. Each individual needs to make their own travel arrangements and room arrangements. We have reserved the executive suite at the Aurora Hotel, which will include a queen sized bed, sofa bed, and lots of space to put a pad and sleeping bag (perhaps 8 people total. This will make it much cheaper for all involved. The Aurora is a nice modern hotel. A couple of other options are the Nugget Inn and the Ocean View Bed & Breakfast. Be prepared for all types of weather and have good hiking shoes.

Words of Wisdom: Don't plant more garden than your spouse can take care of!

Plant Show at the ABG Fair

Carmel Tysver

(Carmel is a Past-President and regular contributor to the Newsletter)

The Alaska Botanical Garden has asked for ARGS to put on a plant show again this year. This will not be a judged show. There will be two tables set up for us to show rock garden plants. I know it's a lot of work but the public likes to view our plants especially ones in bloom. Now is the time to pot up plants and get them ready to show. We can take the plants to the garden on Friday and I will try and get there early afternoon to set the tables up and have tags there to write the name of the plant on and if the plant is uncommon it would be nice to also have information on growth habit and where it is found and any other information about the plant. Plants can also be delivered to the garden early Saturday morning. Also if you have any time that weekend to sit at the booth please let me know.

Carmel Tysver

522 3489

garden@gci.net

2009 Garden Tours Anchorage

This year our garden visits are in Anchorage. Two dates have been chosen: Sunday, June 7th (three small yards) and Saturday July 25 (two large yards on the hillside). Please note the parking restrictions at some locations. It is very important to follow the instructions.

Sunday, June 7, 1–4 P.M.

Garden #1—Verna and Frank Pratt, 7446 E. 20th Ave., Phone 333-8212

Directions: From Muldoon going South turn right on either Island Drive or 20th. From South or West Anchorage turn left on Patterson follow it to 20th.

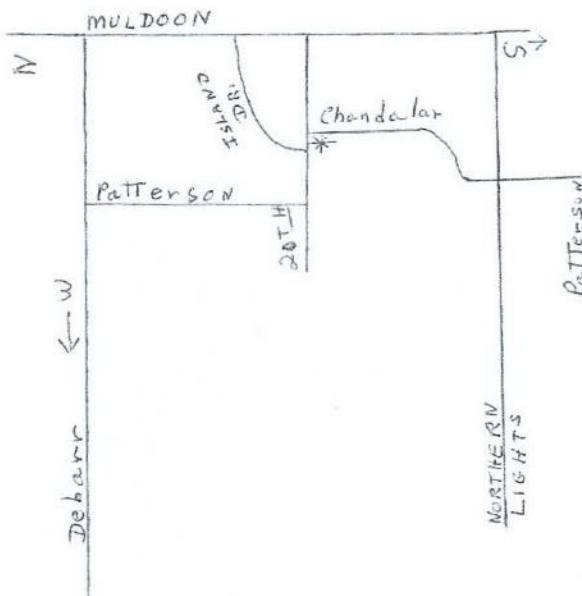

Frank & Verna Pratt's Garden

An avid collector of wild and unusual plants, Verna has one of the foremost collections anywhere. In her garden you will see plants as they would be growing in their native habitat. Teacher, Mentor and cheerleader of anyone interested in growing alpine you will learn something new while visiting this garden and quickly become a fan of the owners.

This exquisite collection of gardens includes: four small Rock Gardens, small pond, troughs, perennials, small vegetable garden, small year round greenhouse, decks with containers of flowers and vegetables.

My Memories of the Pratt's Garden _____

(Continued on Page 3)

2009 Garden Tours Cont'd Sunday, June 7, 1-4 P.M.

Garden #2—Jane and Bob Baldwin 4907 Roger Dr., Phone 562-5451

Directions: From Lake Otis going South, turn right on Waldron (traffic light) and right on Roger Dr. House is on the right.

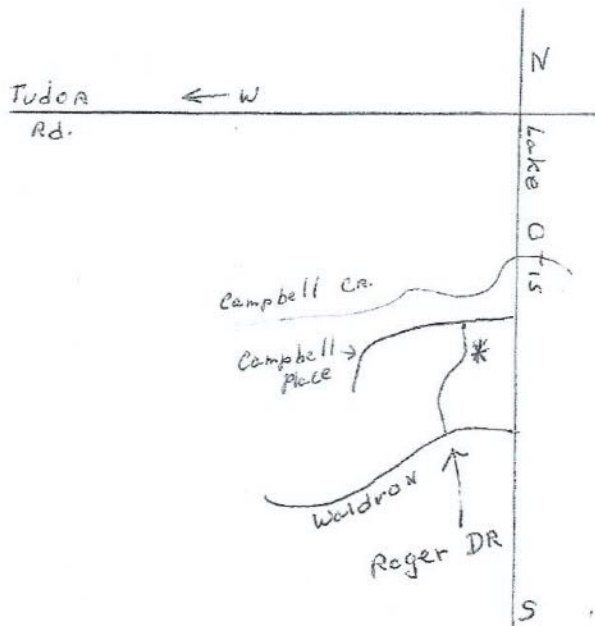

Jane & Bob Baldwin's Garden

A recently redesigned yard as Jane's fascination of primroses grew. You will see lots of primroses, misc. perennials, and veggies in containers.

If you are thinking of growing more primroses and need ideas for varieties and growing conditions this is a must-see garden for you.

My Memories of the Baldwin's Garden _____

(Continued on Page 4)

2009 Garden Tours Cont'd Sunday, June 7th 1-4 PM

Garden #3—Kathy Swick, 2106 North Star St., Phone 258-6678

Directions: From Fireweed Lane, going West, turn right on North Star (1st Street). Park on North Star between Fireweed and 23rd or on 23rd. Walk North on North Star (it turns to the right). It is the last house on the left. This is a dead-end street and the only place to turn around is Kathy's narrow driveway, which has troughs on it. Parking beyond 23rd is very limited and rarely available.

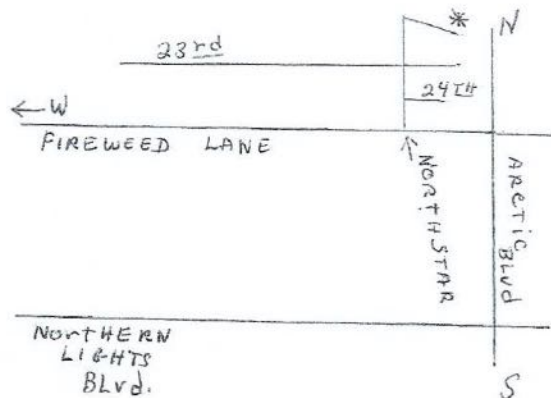

Kathy Swick's Garden

At this garden you will be seeing the front yard only – her only sunny spot. Troughs and Rock Garden with many choice, special, small plants.

Kathy has taken pains to place her special collection of plants to their best advantage. Everything is carefully labeled.

A beautiful display in a small area.

My Memories of Kathy Swick's Garden: _____

2009 Garden Tours - Both on the Hillside - same map Saturday, July 25th 1-4 PM

Garden #1— Madge & John Oswald, 12001 Audubon Dr., Phone 345-5144

Directions: From Birch Rd. (going S.) turn left/East on Downy Finch (From Huffman, turn right/East) and left on Audubon. House is on the right. Their home is being remodeled, so there may be a bit of confusion—driveway might be inaccessible. **Park at the stop sign where you turn onto Audubon.**

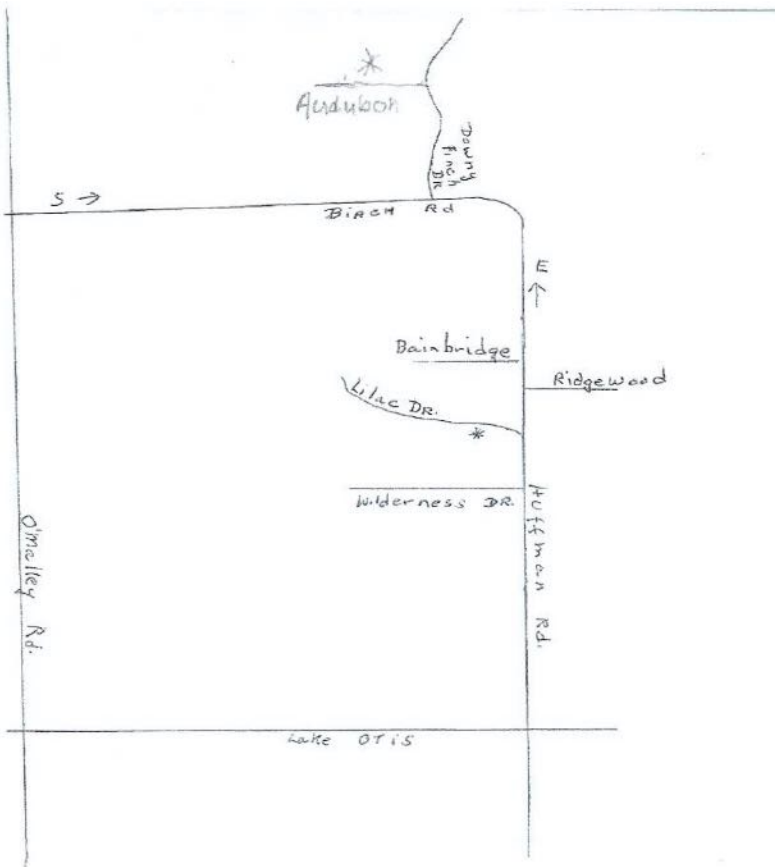

Madge & John Oswald's Garden

This location has lots of perennial gardens, a vegetable garden, a large new rock garden and another one in the making. Madge has made it clear that she "wants it all!" and it shows.

It will be fun to see this garden progress over the years.

My Memories of Oswald's Garden: _____

2009 Garden Tours Cont'd Saturday July 25th 1-4 PM

Garden #2—Amelia & John Walsh, 12330 Lilac Dr., Phone 345-9343

Directions: From Huffman, going East, turn left on Lilac, which is after Wilderness, 1.8 miles from the Seward Highway. From Birch Rd., go south. It becomes Huffman at the bend. Lilac will be on the right. Soon after Ridgewood on the left. Park on Lilac.



John & Amelia Walsh's Garden

At this location you will enjoy a very large rock garden, dahlias, containers, garden art, pond, and a greenhouse.

A plant collector and perfectionist, Amelia has put together a beautiful garden. Her hard work is apparent in every area.

My Memories of Walsh's Garden: _____

Spring is in the Air

Debbie Hinchey

I sure am enjoying the early blooming bulbs of *Chionodoxa*, *Scilla*, *Bulbocodium*, *Muscarri*, and *Narcissus*.

Also, the early *Primulas* are a joy. The *Primula rosea* is usually the first to bloom in hot pink to chase away winter. Some of the *P. juliae* hybrids, 'Dorothy'-look-alikes, auriculas, and a dwarf *P. dentiucula* are great in perennial beds. *P. allonii* and *P. marginata* are as charming as can be in the rockier areas.

For the first time I have tried *Hepatica* with one now blooming. I have to say, that if I did not know to look for them, I would miss them in the heavy mulch under my big May Day tree.

Plant Sale at ABG

ARGS will once again be selling plants at the ABG Fair on June 20th & 21st. Our location will be the same as last year—through the ABG Sales area and down the path toward the food vendors—we are Spaces 5 & 6 on the left. To bring plants you can arrange to bring your vehicle in on Friday afternoon or early Saturday morning. Please call Verna as Suzanne from ABG will be working with her designating times throughout the day so that there isn't so much confusion. Let Verna know if you plan to bring a vehicle in to unload so that she can schedule your time. If you are coming Saturday morning there will be a four-wheeler with a trailer to assist you in bringing plants in (schedule ahead) or you can use a hand wagon to bring them in.

Be sure and have your plants marked with correct name and a price label with your initials on it for each plant. If you can work at the sale Verna will set up a time with you.

Parking passes will be available for the people who are actually working at the sale. There are only a few, so if you plan to work at least a couple of hours you may get one..

For those folks who are just visiting the ABG Fair - don't miss it - Parking is at the Alaska Club East parking lot or the Park & Walk at Chugach Square. There will be shuttle buses going all day.

Join or Renew Your Membership

To join the Alaska Rock Garden Society, fill out the form below and send, along with a check payable to ARGS to: Alaska Rock Garden Society, PO Box 244136, Anchorage, AK 99524-4136

ARGS Membership: New _____; Renewal _____; w/o Changes _____; w/change _____
Dues: \$15 US—Individual, \$20 US—Family/Canada, \$25 US—Foreign

Name: _____

Address: _____

City: _____, State: _____, Zip: _____

E-mail Address: _____ Telephone: (_____) _____ - _____

ARGS may share its membership list with like-minded, non-profit organizations. If you DO NOT want to receive these notifications, please check here: _____

Membership is for the calendar year



Newsletter

Alaska Rock Garden Society
PO Box 244136
Anchorage, AK 99524-4136

We're on the Web
www.args.org